



Young's Products LLC
4330 S. Johnson Rd., Chanute, KS 66720
800-837-8578
www.popuphitch.com info@popuphitch.com

Installation Instructions

119R2 Dodge Ram 129R2 Mega Cab

Fits 2002-2008 1/2 Ton
Fits 2003-2010 3/4 & 1 Ton
Long & Short Bed



Patent Pending

Model 119R2 and 129R2 09/09

WARNING Most pick up trucks have **FUEL LINES** and/or **BRAKE LINES** and/or **ELECTRICAL WIRING** positioned along the truck frame rails where your PopUp will install. **BEFORE INSTALLATION** identify and examine the location of fuel lines, brake lines and electrical wires. Be sure you will not damage fuel lines, brake lines or electrical wiring when positioning the hitch components, drilling holes or tightening fasteners. **Be Certain To Avoid Fuel Tanks When Drilling Holes.**

- Wear Safety Glasses, Gloves and Particle Mask for protection while installing a PopUp gooseneck hitch.
- ALWAYS correctly chock tires prior to raising truck with jacking device. For protection in case of jacking device failure ALWAYS use Jack Stands when working under or around a truck which has been raised by a jacking device.
- Be certain the exhaust system is cool prior to installation to avoid possible burns from hot tail pipe and muffler.
- Torque ALL fasteners used in the PopUp gooseneck hitch installation as specified in these Installation Instructions.

WARNING: Verify adequate trailer swing clearance between trailer nose and cab of truck, and trailer and rear of truck.

1. Center the hole for **SHORT BED TRUCKS** at **45 1/2"** or for **LONG BED TRUCKS** at **47 1/2"** from the rear lip of the truck bed floor (tailgate end) centered between the wheel wells. Use a 3" hole saw to cut a hole in the bed floor centered at this location. Smooth hole edges with file after sawing. Clean all saw tailings from the bed area before proceeding.

2. If so equipped, cut and remove the tail pipe heat shield between the two truck bed cross members ahead of and rearward of the axle where the hitch will install. Some models have a **plastic fender liner** that you may simply remove to install the hitch. Re-install the liner and use your 3" hole saw to make an access hole to the pull rod.

3. Locate the bed sill that is forward of the hole for the ball. Measure back 4 1/2" on the bed lip and cut out a section as shown. This will allow the angles to be passed across the top of the frame and give clearance for the actuating rod.

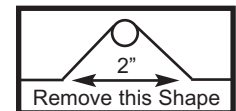

4. Pass the **Front Bar Cross Member** across the frame rails of the truck from the driver side with the **1/4" spacers** on the bottom for 3/4 and 1 ton trucks or on the top for 1/2 ton trucks. Center the Front Bar Cross Member across the frame about three inches in front of the 3" hole.

5. Pass the **Rear Angle Cross Member** across the frame rails similarly, with the plain side (2" leg) up and with the hole leg facing forward. **If installing a 119** position the Rear Angle Cross Member across the frame about 5" rearward of the 3" hole in the bed floor. For the **129** move the Rear Angle against the truck bed sill located behind the 3" hole in the bed floor.

6. With the ball tube assembly closest to the front of the truck, raise the Center Assembly (3) into position between the Cross Members. Using the eye bolt in the top of the ball hold the Center Assembly firmly against the underside of the bed floor using an overhead lifting device or a saw horse in the bed of the truck, and chain or rope secured to the eyebolt. Insure that the top of the Center Assembly channel is flush with the bottom of the bed floor.

7. Fasten the Center Assembly to the Front Cross Member with 1-1/4" bolts. Slide the Rear Cross Member forward and fasten it to the Center Assembly with 1-1/4" bolts with washers on the slotted holes and 1/2" nuts. Do not fully tighten these fittings at this time. Square the assembled Cross Members and Center Assembly across the frame from to back and side to side.

8. Identify the driver side Frame Plate (pictured) and passenger side Frame Plate. Position the Frame Plate extension tabs between the Cross Members. **Remove the brake cable bracket if necessary.** Fasten the Front Cross Member to the Frame Plates using a flat washer and 1/2" nut on the bent tang of the Frame Plate. Fasten the Rear Cross Member by passing a 1-1/4" bolt with a flat washer from the Frame Plate and securing with a flat washer and 1/2" nut. *Do not fully tighten these fittings at this time.* (over)

INSTALLATION PROCEDURE - CONTINUED

9. Square the hitch across the frame. Loosen any tension from the overhead lifting device so that the bar and angle are resting on the truck frame.

10. Secure the Frame Plates to the frame using one u-bolt and one 1/2" x 7" bolt. The 7" bolt goes thru the existing vertical hole in the frame from underneath with a flat washer against the bottom of the frame. **Note: There are four U-Bolts in the hardware kit. The two wide bolts are used for 3/4 and 1-Ton trucks and the narrower ones are for use in 1/2 ton trucks. See photo for proper placement of the U-Bolts.** **Caution:** Avoid brake and electrical lines when positioning U-Bolt against truck frame.

CAUTION: Use this sequence for tightening Frame Plate fasteners: 1. Snug the center section to the cross rails. 2. Snug the Cross rails to the side plates. 3. Snug the frame plate u-bolt and the 7" bolt. Using the same sequence, torque these fittings to **65 Foot Pounds. Use a Torque Wrench. Do not overtighten. Make certain that the cross bar and cross angle are resting on truck frame before tightening fasteners.**

11. If the brake cable bracket was removed from frame in Step 8, mount it using the sq. hole in the bottom of the Driver Side Frame Plate using the 5/16" lock nut.

12. From the driver side, pass the Actuating Rod thru the hole between the Frame Plate extensions and into the slide. Align the Actuating Rod so the set screw seats in the hole provided in the rod, and tighten to 15 foot pounds. You may need to remove some of the fender lip above where the Actuating Rod installs to allow free travel.

13. Drill four 1/2" holes for the Safety Chain Brackets from under the truck bed. Drill through the two pairs of holes in the Center Assembly that are **farthest from the hitch ball**. Place a U-bolt in each pair of holes from the top side of the bed. From under the bed place a spring and 1/2" nut on each U-bolt leg. Tighten each nut until thread extends through the nut.

14. Make sure that the slide works freely in and out. Keep the PopUp ball lightly lubricated with lithium grease.

16. Please read the **SAFE TOWING INSTRUCTIONS** on the PopUp WARRANTY sheet.

2010 Trucks

Some 2010 trucks have a ground wire on the side of the frame. Simply disconnect the wire, install the hitch, then run the wire thru the slot and reconnect as shown.

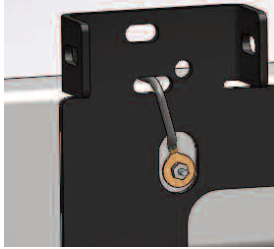

Provision for ground wire added 3-1-2010

HARDWARE PROVIDED

- 12 - 1/2" X 1-1/4" Grd. 8 Hex Bolts
- 2 - 1/2" X 7" Grd. 8 Hex Bolts
- 12 - 1/2" Hex Lock Nuts
- 12 - 1/2" Flat Washers
- 2 - 5-3/4" wide U-Bolts
- 2 - 6-11/16" wide U-Bolts
- 1 - 5/16" Set Screw
- 2 - U-Bolt Assemblies (for safety chains)
- 1 - 3/8" Eye Bolt
- 1 - 5/16" Lock Nut (use when relocating brake cable hanger)
- 1 - Plastic Cap

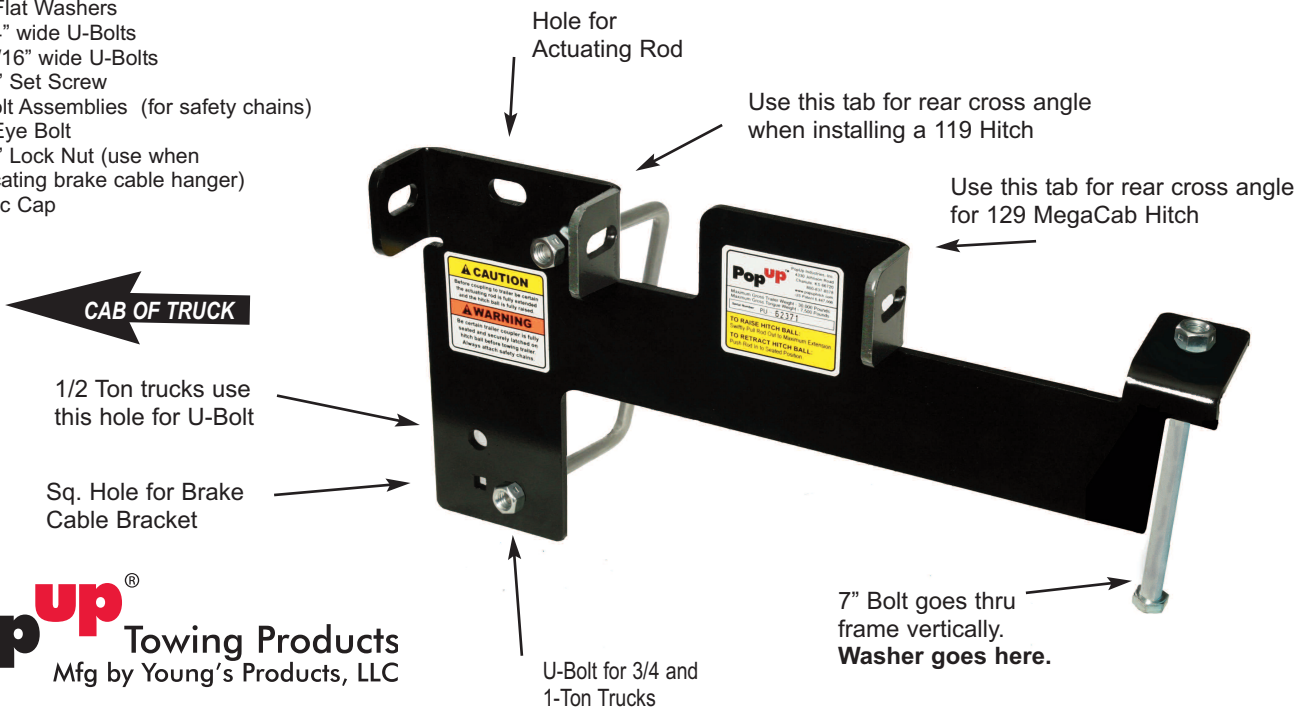

PopUp®
Towing Products
Mfg by Young's Products, LLC

Model Number 119R2 and 129R2
Gross Trailer Weight: 30M lbs.
Gross Trailer Tongue Weight: 7.5M lbs.

Patent Pending

